

X50V9

ALL IN ONE PC

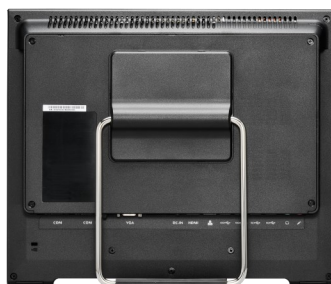

PROCESSOR	Intel® Processor U300 / Celeron® 7305 / Core i3-1315U 15W CPU options	
MEMORY	2 x DDR5-5200 SODIMM slots (DDR5-4800 w/ Celeron CPU), Supports dual channel up to 64GB (32GB x 2)	
VIDEO GRAPHICS	Intel UHD graphics	
VIDEO OUTPUT	HDMI 2.0b + VGA/D-sub, Supports two additional displays	
AUDIO	Realtek ALC888S, 2W x 2 speakers	
ETHERNET	Intel i219 10/100/1000 Mbps operation	Supports Wake on LAN function
STORAGE INTERFACE	2.5" SATAIII device bay x 1	
FRONT PANEL	(1) Power LED (1) HD Webcam (1) Microphone	(1) HDD/SSD LED (2) Stereo speakers (1) Touchscreen LCD display
SIDE PANEL	(1) Power on Button (1) Hole w/ Clear CMOS button	(2) USB 3.2 Gen 1 (1) Stylus pen
BACK & BOTTOM PANEL	(1) HDMI 2.0b port (1) VGA port (1) Kensington Lock (2) USB 3.2 Gen 1 (2) USB 3.2 Gen 2 (1) USB 2.0 (internal) (1) DC-input	(4) Hole for optional WLAN/LTE antenna (2) Optional COM (PCP11) (1) RJ45 Gigabit LAN (1) Microphone input (1) Headphone output 100 x 100 mm VESA mount holes
DRIVE BAYS	(1) 2.5" HDD/SSD bay	
DIMENSIONS	15.4(L) x 1.7(W) x 12.9(H) inches	
POWER	90W 19V power supply	
ACCESSORIES	Quick Guide 90W power adapter Power cord	Driver DVD Screw package
EXPANSION SLOT	(2) M.2 2280 M key	(1) M.2 2230 AE key (Wi-Fi pre-installed)
OS SUPPORT	Windows 11 64 bit, Linux 64 bit	

BIOS DOWNLOADS: <https://global.shuttle.com/products/productsDownload?pn=X50V9%20SERIES>

SUPPORT LIST: <https://global.shuttle.com/products/productsSupportList?pn=X50V9%20SERIES>

FAQ LIST: <http://global.shuttle.com/support/faq>

PRODUCT WARRANTY: <https://www.shuttlecomputers.com/policies>

For more information on all products, please contact us at sales@us.shuttle.com or 626.820.9000

© 2024 Shuttle Computer Group, Inc. All rights reserved. Specifications are subject to change without notice. Not responsible for any photographic or typographic errors. Photos shown may vary from actual look. Intel, the Intel logo, Intel Core and Intel Celeron are trademarks of Intel Corporation or its subsidiaries in the US and/or other countries. ©Intel Corporation

X50V9

ALL IN ONE PC

CHASSIS	Black chassis (white option also available) Mounting hole for Kensington Lock Dimensions: 15.4 (L) x 1.7 (W) x 12.9 (H) inches Weight: 7.7 LBS (net) / 9.25 LBS (gross)															
POWER SUPPLY	External 90W power adapter (fanless), 3-pin AC main cable AC input voltage: 100 - 240V, 50/60 Hz, max 1.6A Output: 19V DC 4.74A															
OPERATING SYSTEM	The system comes without an operating system installed. Compatibility: Windows 10/11 64 bit, Linux 64 bit															
PROCESSOR SUPPORT	Intel® Celeron® 7305 (Core i3-1315U option for X50V9U3) 10 nm structure, Alder Lake-U platform CPU cores/threads: 4/4, L3 cache: 8 MB CPU clock frequency: 1.1 GHz Max supported processor power consumption (TDP): 15W System on chip processor (SoC) with integrated graphics processor, no chipset required															
FANLESS COOLING	Passive heatpipe cooling, no fan noise at all Suitable for noise sensitive environments Fanless, dust-free and virtually maintenance free															
MEMORY SUPPORT	2 x 262 pin SODIMM slots Supports DDR5-4800 SDRAM at 1.1V Supports Dual Channel mode Supports a max. of 32GB per DIMM, up to 64GB total (2 x 32 GB) Supports two unbuffered DIMM module (no ECC or registered), two thermal pads for RAM modules included															
STORAGE	Supports one 2.5" SATA hard disk or SSD drive, max height 9.5 mm Supports SATA III, 6 GB/s bandwidth, SATA cable pre-installed															
M.2 SLOT	M.2 2280 M slot provides the following interfaces: Supports M.2 cards with a width of 22 mm and a length of 80 mm (type 2280), second slot can also be used for WWN04 optional kit (supports 4G/5G wireless network card) Supports M.2 SATA SSDs (one M.2 SSD card with PCIe/NVMe interface supported, second M.2 SSD must have SATA interface) <table><tr><th>M.2 Slot</th><th>Interfaces</th><th>Config 1</th><th>Config 2</th><th>Config 3</th></tr><tr><td>Slot 1 CN6, above</td><td>PCIe Gen 4 x4 & SATA 3.0</td><td>M.2 SSD card (SATA)</td><td>M.2 SSD card (PCIe/NVMe)</td><td>M.2 SSD card (SATA)</td></tr><tr><td>Slot 2 CN5, below</td><td>PCIe Gen 4 x4 & USB 3.2 Gen 2</td><td>M.2 SSD card (PCIe/NVMe)</td><td>Optional WWN04 kit</td><td>Optional WWN04 kit</td></tr></table> Two thermal pads for the M.2 SSDs are included (70 x 20 x 5.5 mm)	M.2 Slot	Interfaces	Config 1	Config 2	Config 3	Slot 1 CN6, above	PCIe Gen 4 x4 & SATA 3.0	M.2 SSD card (SATA)	M.2 SSD card (PCIe/NVMe)	M.2 SSD card (SATA)	Slot 2 CN5, below	PCIe Gen 4 x4 & USB 3.2 Gen 2	M.2 SSD card (PCIe/NVMe)	Optional WWN04 kit	Optional WWN04 kit
M.2 Slot	Interfaces	Config 1	Config 2	Config 3												
Slot 1 CN6, above	PCIe Gen 4 x4 & SATA 3.0	M.2 SSD card (SATA)	M.2 SSD card (PCIe/NVMe)	M.2 SSD card (SATA)												
Slot 2 CN5, below	PCIe Gen 4 x4 & USB 3.2 Gen 2	M.2 SSD card (PCIe/NVMe)	Optional WWN04 kit	Optional WWN04 kit												
AUDIO	Realtek® ALC888S audio codec, Digital Audio supported via HDMI Two analog audio connectors (3.5 mm) on the bottom panel: Line-out (headphones), Microphone input															
WIRED NETWORK	Supports 10/100/1000 Mbps operation Intel i219 ethernet controller Supports Wake on LAN from S3, S4 modes Supports network boot by Preboot eXecution Environment (PXE)															
WIRELESS NETWORK	Two internal WLAN antennas, M.2 2230 AE key slot supports PCIe Gen 3 x1, USB 2.0, CNVi WLAN controller Realtek RTL8821CE Supports Wi-Fi IEEE 802.11 b/g/n/ac on 2.4/5 GHz band, 1T1R Supports 20/40/80 MHz channel bandwidth, supports Bluetooth 4.2 on 2.4 GHz band Supports WPA(-PSK), WPA2(-PSK), WEP 64/128 bit, IEEE 802.11x, IEEE 802.11i															
WEBCAM	Integrated Full HD webcam (1920 x 1080 pixels)															

X50V9

ALL IN ONE PC

INTEGRATED GRAPHICS	<p>Intel UHD graphics for 12th Gen Intel® Core™ Processors, GPU clock rate: 1100 MHz</p> <p>Up to three displays simultaneously, two additional screens are supported: -HDMI 2.0b (1920 x 1080/60 Hz or 3840 x 2160/60 Hz) -VGA analog video (1920 x 1080/60 Hz)</p> <p>Conditions for operation in Multi-Monitor mode: Clone mode: all displays show the same content at 1366 x 768 resolution Extended mode: all displays show different content</p>	
IP54 PROTECTED	The front panel is dust and splash water protected with protection class IP54	
TOUCHSCREEN	<p>15.6" LCD display, 16:9 widescreen panel (1366 x 798 px), 1.05 Megapixel High power LED, Luminance: 220 cd/sqm, Glass thickness: 3.2 mm Resistive 5 wire single touch technology Stylus for screen included, screen supports fingertip input</p>	
BIOS	<p>AMI BIOS in 32 MB EEPROM with SPI interface Supports power fail resume / always on Supports Wake-on-LAN from S3, S4, S5 ACPI states Supports hardware monitoring and watch dog functionality Supports Firmware TPM v2.0 functionality</p>	
MICROPHONE/SPEAKERS	Front panel integrated with Electret Condenser Microphone and 2 x 2W speakers	
ONBOARD CONNECTORS	Internal USB 2.0 type A for USB stick Serial ATA 6 GB/s & power connector	Serial interfaces for optional COM ports x 2 (2x5 pin, 2 mm pitch) Other available connectors occupied by integrated components
BACK/BOTTOM CONNECTORS	HDMI 2.0b (video/audio) VGA connector (D-sub 15 pol., analog) USB 3.2 Gen 2 x 2 (max 10 Gbps, red) USB 3.2 Gen 1 x 2 (max 5 Gbps, blue) Kensington Lock	Microphone input (3.5 mm) Headphones output (3.5 mm) DC input for external power adapter Gigabit LAN RJ45 (Intel i219) Optional COM x 2 (RS232 x 1, RS232/422/485 x 1)
SIDE CONNECTORS	Perforation for external antennas x 4 USB 3.2 Gen 1 x 2 (max 5 Gbps, blue) Power button	Hole for Clear CMOS button Hole for power button
INCLUDED ACCESSORIES	XPC installation guide Driver DVD Screw packs	External 90W/19V power adapter with cord Thermal Pads for SSD M.2 Thermal Pads for RAM modules
OPTIONAL ACCESSORIES	COM port adapter (PCP21/PCP11): -PCP21 x 1 or PCP11 x 2 -Provides 2 COM ports (RS232 x 1, RS232/422/485 x 1) on bottom side WLAN kit (WLN-M1)	4G/5G kit (WWN04): The kit includes an adapter board for lower M.2 2280 slot For mobile network, the following is required: -4G/LTE card in M.2 3042 format or 5G card in M.2 3052 format -an activated nano SIM card
ENVIRONMENTAL CRITERIA	Operating temperature: 0 - 40°C	Humidity: 10 - 90% (non-condensing)
CERTIFICATIONS	<p>EMI: CE, UKCA, FCC, BSMI, RCM, VCCI Safety: CB, cTUVus, BSMI</p> <p>Other: RoHS, Energy Star v8.0, ErP Lot3</p> <p>This model is classed as a technical information equipment (ITE) in class B and is intended for use in living rooms and offices. The CE mark approves conformity by the EU directives: (1) 2014/30/EU relating to electromagnetic compatibility (EMC) (2) 2014/35/EU relating to Electrical Equipment designed for use within certain voltage limits (LVD) (3) 2009/125/EC relating to eco-design requirements for energy related products (ErP) (4) 2014/53/EU related to Radio Equipment Directive (RED)</p>	

BIOS DOWNLOADS: <https://global.shuttle.com/products/productsDownload?pn=X50V9%20SERIES>

SUPPORT LIST: <https://global.shuttle.com/products/productsSupportList?pn=X50V9%20SERIES>

FAQ LIST: <http://global.shuttle.com/support/faq>

PRODUCT WARRANTY: <https://www.shuttlecomputers.com/policies>

For more information on all products, please contact us at sales@us.shuttle.com or 626.820.9000

X50V9

ALL IN ONE PC

Front View and Back View



- | | | | |
|---|-----------------|---|---------------------|
| 1 | HD Webcam | 4 | Power on LED |
| 2 | Microphone | 5 | Hard Disk LED |
| 3 | Touchscreen LCD | 6 | Stereo speakers x 2 |

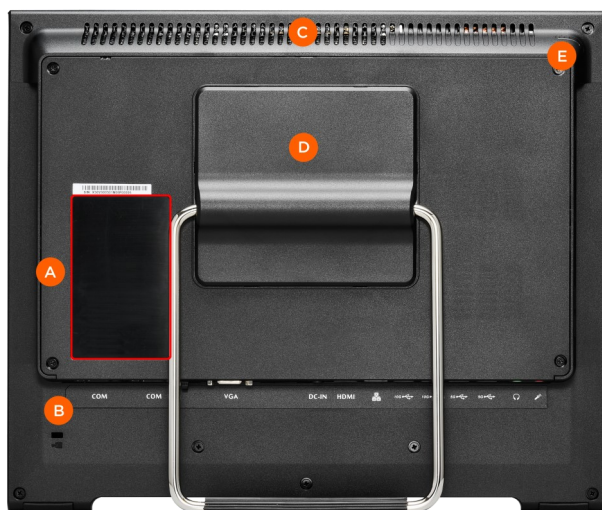

- | | | | |
|---|-----------------|---|--------------------|
| A | Rating Label | D | Stand (handle)* |
| B | Kensington Lock | E | Stylus with holder |
| C | Cooling vents | | |

*remove handle to reveal VESA mount holes

For more information on all products, please contact us at sales@us.shuttle.com or 626.820.9000

© 2024 Shuttle Computer Group, Inc. All rights reserved. Specifications are subject to change without notice. Not responsible for any photographic or typographic errors. Photos shown may vary from actual look. Intel, the Intel logo, Intel Core and Intel Celeron are trademarks of Intel Corporation or its subsidiaries in the US and/or other countries. ©Intel Corporation

X50V9

ALL IN ONE PC

Side and Bottom View

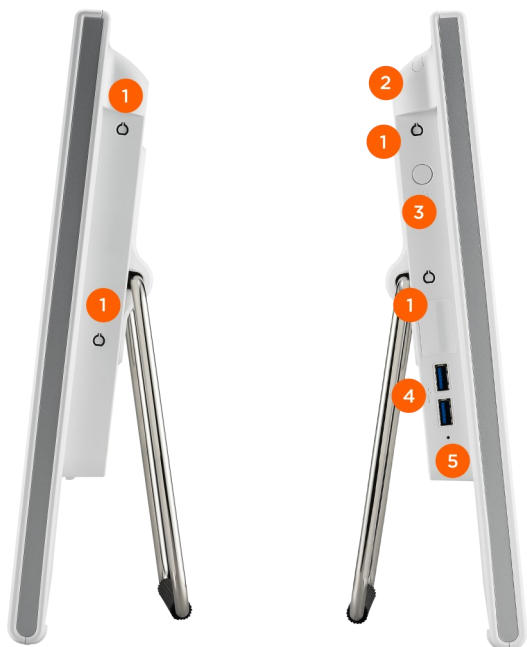

- 1 Perforation for antenna
- 2 Stylus with holder
- 3 Power Button
- 4 USB 3.2 Gen 1 x 2
- 5 Hole for hidden Clear CMOS button

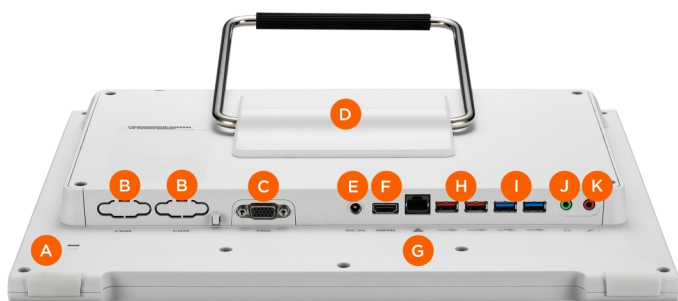

- A Kensington Lock
- B D-sub COM port x 2 (optional)
- C D-sub/VGA output
- D Stand (handle)*
- E DC input for power adapter
- F HDMI 2.0b port
- G RJ45 LAN port
- H USB 3.2 Gen 2 x 2
- I USB 3.2 Gen 1 x 2
- J Headphone output
- K MIC input

*remove handle to reveal VESA mount holes

For more information on all products, please contact us at sales@us.shuttle.com or 626.820.9000

© 2024 Shuttle Computer Group, Inc. All rights reserved. Specifications are subject to change without notice. Not responsible for any photographic or typographic errors. Photos shown may vary from actual look. Intel, the Intel logo, Intel Core and Intel Celeron are trademarks of Intel Corporation or its subsidiaries in the US and/or other countries. ©Intel Corporation

X50V9

ALL IN ONE PC



EQUIPPED WITH INTEL® ALDER/RAPTOR LAKE-U

The X50V9 supports Intel® Alder/Raptor Lake-U platform technology with an Intel® Celeron® 7305 / Core™ i3-1315U processor*. It supports up to DDR5 5200 MHz memory (up to 64 GB) with Intel® UHD graphics for Ultra HD/4K video playback.

*Core i3 processor option available



IP54 CERTIFIED DESIGN

The front panel of the X50V9 is IP54 certified for dust and splash water resistance, suitable for indoor applications where there touch screen may be exposed to humidity and the occasional splashing of water.



GREAT CONNECTIVITY WITH MULTIPLE I/O

With upgraded I/O interfaces like USB 3.2 Gen 2 and optional RS232 ports, the X50V9 suitable for applications like kiosks, digital signage, and point-of-sales setups. The seamless connectivity also extends to peripherals such as cash drawers, thermal printers, and barcode scanners.



FANLESS DESIGN

With a passive thermal cooling system, the fanless design reduces power consumption required and noise caused by a fan. Suitable to be used in noise sensitive environments and is virtually maintenance free.



24/7 NONSTOP OPERATION

Officially approved for 24/7 nonstop operation, the X50V9 keeps things cool and stable for long term demands of applications.*

*If HDD is installed, it must be approved for 24/7 operation by manufacturer

For more information on all products, please contact us at sales@us.shuttle.com or 626.820.9000

© 2024 Shuttle Computer Group, Inc. All rights reserved. Specifications are subject to change without notice. Not responsible for any photographic or typographic errors. Photos shown may vary from actual look. Intel, the Intel logo, Intel Core and Intel Celeron are trademarks of Intel Corporation or its subsidiaries in the US and/or other countries. ©Intel Corporation

X50V9

ALL IN ONE PC



ACCESSORY	PCP11
DESCRIPTION	The PCP11 accessory can be used to add a COM port on the X50V9 (up to two can be equipped).
COMPATIBILITY	P20U/P22U/P51U/P52U series, DS10U/DS20U/DS50U series, XH410G/XH510G/XH510G2, SH610R4, X50V9
PORTS	External: Sub-D, 9-pin, male Internal: 10-pin (2x5), female, 2 mm pitch



ACCESSORY	WLN-M1
DESCRIPTION	The WLN-M1 wireless LAN kit can be used to equip select XPC models with the wireless LAN standard 802.11 b/g/n/ac/ax at 2.4/5 GHz. The combo device supports Bluetooth 5.2.
ITEMS INCLUDED	M.2 2230 (NGFF) WLAN card, XPC slim antenna cables x 2 (8.3 in and 11.4 in), XPC cube antenna cables x 2 (20.8 in), Dipole antennas x 2, Quick guide, Driver DVD
OS SUPPORT	Windows 10, Windows 11, Linux (64 bit)

For more information on all products, please contact us at sales@us.shuttle.com or 626.820.9000

© 2024 Shuttle Computer Group, Inc. All rights reserved. Specifications are subject to change without notice. Not responsible for any photographic or typographic errors. Photos shown may vary from actual look. Intel, the Intel logo, Intel Core and Intel Celeron are trademarks of Intel Corporation or its subsidiaries in the US and/or other countries. ©Intel Corporation

X50V8 vs X50V9

ALL IN ONE PC



MODEL	X50V8	X50V9
CHIPSET	Intel Celeron 5205U Intel Core i3-10110U (X50V8U3)	Intel Celeron 7305 Intel Core i3-1315U (X50V9U3)
PROCESSOR SUPPORT	SoC, max TDP 15W, 1.9 GHz 14nm Comet Lake-U	SoC, max TDP 15W, 1.1 GHz 10nm Alder Lake-U
MEMORY	2 x 32 GB DDR4 2400 MHz max	2 x 32 GB DDR5-4800 MHz max (5200 for i3-1315U)
VIDEO OUTPUT	HDMI 1.4b + VGA, Supports two additional displays, Supports 4K Ultra HD	HDMI 2.0b + VGA, Supports two additional displays, Supports 4K Ultra HD
GRAPHICS	Intel UHD Graphics (for 10th Gen Intel® Core™ processors)	Intel UHD Graphics (for 13th Gen Intel® Core™ processors)
AUDIO	Realtek AL269 or C-Media CM6542, HD audio	Realtek ALC888S, HD audio
ETHERNET	Intel i211 or i219LM Gigabit LAN 10/100/1000 Mbps operation Supports Wake on LAN function	Intel i219 Gigabit LAN 10/100/1000 Mbps operation Supports Wake on LAN function
WIRELESS LAN	IEEE 802.11 b/g/n/ac (2.4/5 GHz band) Internal antenna x 2 Supports Bluetooth 4.2 on 2.4 GHz band	IEEE 802.11 b/g/n/ac (2.4/5 GHz band) Internal antenna x 2 Supports Bluetooth 4.2 on 2.4 GHz band
TPM	Supports Firmware TPM v2.0	Supports Firmware TPM v2.0
SSD CARD SUPPORT	M.2 2280 BM (PCI-E X4/NVMe or SATA)	M.2 2280 M (PCI-E X4/NVMe or SATA)
SIDE/BACK PANEL	HDMI 1.4b, VGA USB 3.2 Gen 1 x 4, USB 2.0 x 2 Gigabit LAN (RJ45) Hole w/ Clear CMOS button	HDMI 2.0b, VGA USB 3.2 Gen 1 x 4, USB 3.2 Gen 2 x 2 Gigabit LAN (RJ45) Hole w/ Clear CMOS button COM x 2 (optional)
DRIVE BAYS	(1) 2.5" HDD/SSD bay	(1) 2.5" HDD/SSD bay
OPTIONAL ACCESSORIES	COM/LPT adapter (PCL71) COM/LPT/RJ11 adapter (POS01)	COM adapter (PCP11) WLN-M1 (WLAN kit) WWN04 (4G/5G kit)
EXPANSION SLOT	M.2 2280 BM slot M.2 2230 AE slot	M.2 2280 M slot x 2 M.2 2230 AE slot
OS SUPPORT	Windows 10/11 64 bit, Linux (64 bit)	Windows 10/11 64 bit, Linux (64 bit)

For more information on all products, please contact us at sales@us.shuttle.com or 626.820.9000

© 2024 Shuttle Computer Group, Inc. All rights reserved. Specifications are subject to change without notice. Not responsible for any photographic or typographic errors. Photos shown may vary from actual look. Intel, the Intel logo, Intel Core and Intel Celeron are trademarks of Intel Corporation or its subsidiaries in the US and/or other countries. ©Intel Corporation